

A VISION
AHEAD



HOW TO READ THE PRODUCT KEY

| Manufacturer | Source colour | Light Output Area/Length | Injection process | Input voltage |
|--------------|---------------|--------------------------|--|----------------|
| PHLOX | - LEDW | - BL 200x200 | - HSCAT | - Q - 1R - 24V |
| Source type | Product type | Range | Number of light sources' rows per cicu | |

NEW !

PHLOX® EXCLUSIVE LIGHT PROCESS
WORLDWIDE PATENT ISSUED

HSCAT (High Speed Camera) White led Backlight 200x200 + Power supply

PHLOX - LEDW - BL - 200x200 - HSCAT - Q - 1R - 24V

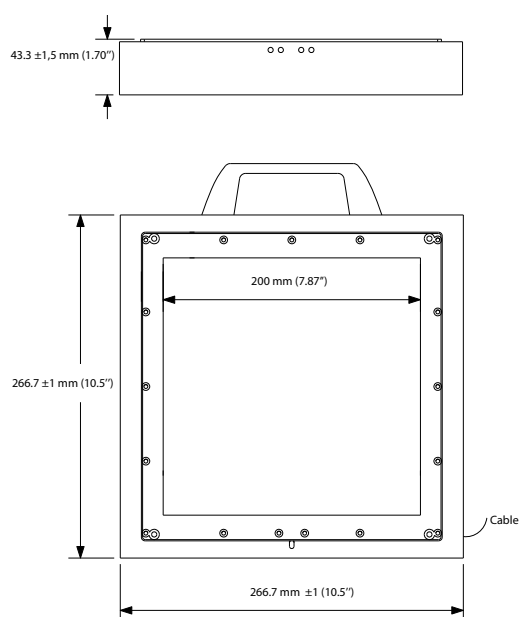

HSC Backlights by PHLOX®, designed for the Phantom® High Speed Camera offer the best luminance on the market.

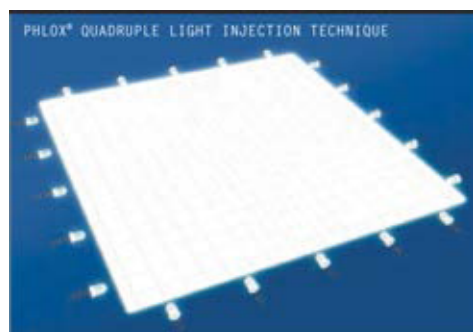

INNOVATION

PHLOX® uses optical processes: a PMMA pipe lighted by a linear source made up of LED (Light Emitting Diodes). Our manufacturing process (CO2 laser) enables us to combine refraction and diffusion which improves backlight luminance. Up to 90% of the light injected can be reemitted on the surface. Thanks to the use of mathematical models, PHLOX® emits light in a determinist and perfectly controlled manner

Illumination

Luminance minimum
Uniformity minimum
Source Type
Colour Temperature
Light Angular Distribution
Expected Life

≥140000 cd/m² continuous mode
≥95% (+/- 10%)
White LED
5700°K (+/-500)
30° 1/2 angle (less stray light)
> 20 000 hours

Scan for DS
and 3D Files !



Electrical

Input Voltage
Input Current
Cable length
Connector
CE Conformity
Strobe mode
Power supply (included)

24 VDC (continuous mode)
≤5 A (continuous mode)
3.7 M - Ø 3,6 mm (12.14 ft - Ø 0.142")
XLR3 male on backlight and XLR3 female on PSU
Yes
Max. Cur: 32A / Pulse Width: 10ms / Duty Ratio: 1/10
MeanWell 24V, 5A (GST20A24-P1M)*
* replaced by a 48V power supply if ordered with a PHLOX Strobe light

Outer unit

L x W x H

340.7 x 266.7 x 43.3 mm (13.41 x 10.5 x 1.70")
handle and anchoring device included
Black Anodized Aluminium
3850 g (135.8 oz)

Housing Material
Weight

Environmental

Max. Operating Humidity
Operating Temperature
Storage Temperature
Shelf life
Max.temp.on housing

95% non-condensing
40°C (104°F) max
50°C (122°F) max
12 months from date of purchase
110°C (+230°F) max

30mm all along the edges of the back of the black anodized aluminium housing (see image)

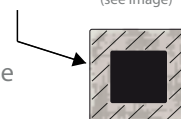

Do not cover the backlight when it's switched on.

Accessories

LED Dimmer 28V-5A very compact and easy to use
Product key: PHLOX DIM LIGHT

LED Strobe 48V - 5A (up to 40A in pulse mode)
Pulse width between 2µs and 10ms
Product key: PHLOX STROBE LIGHT



DESIGNED FOR YOUR APPLICATION

Shadowgraphy, Particle analysis, Ballistics, Spray analysis (water, paint, fuel, etc...)
Droplet impaction, Bubble formation, Powder, solid particles, Emulsions and dispersions
Welding, Liquid interface

CLASS 0: NO RISK (CIE S2009:2002/NF EN 62471)

RoHS directive compliant

Each PHLOX Backlight is provided with:

- 24 months warranty
- Certificate of uniformity and luminance
- Seal of quality on the back

July 15, 2022

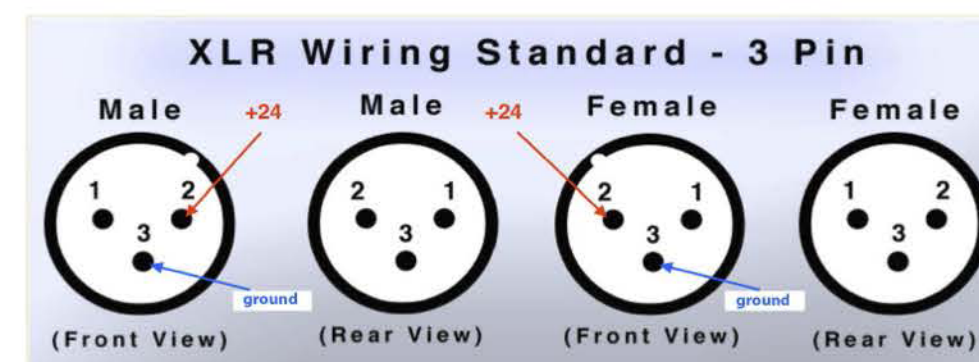
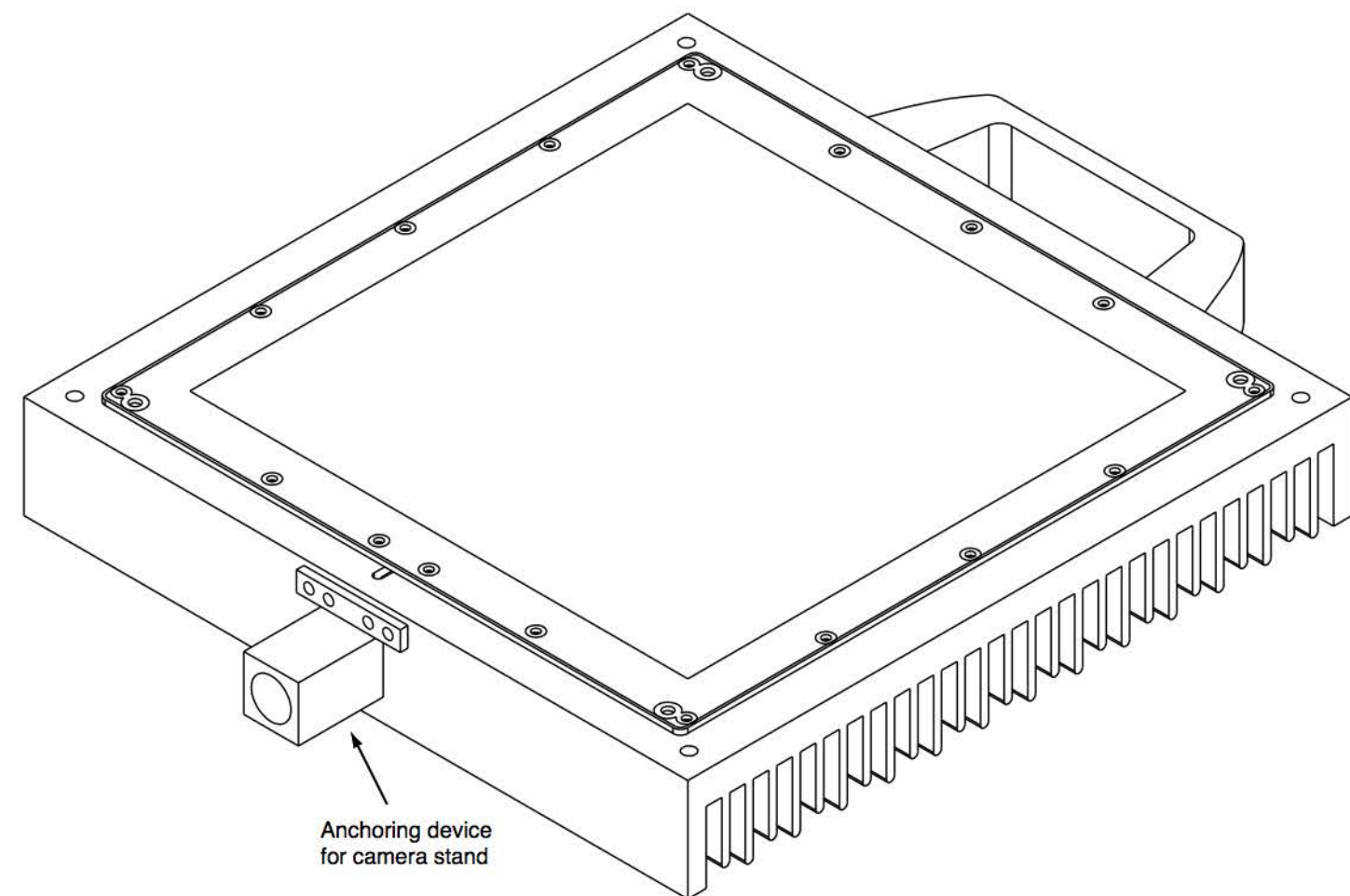
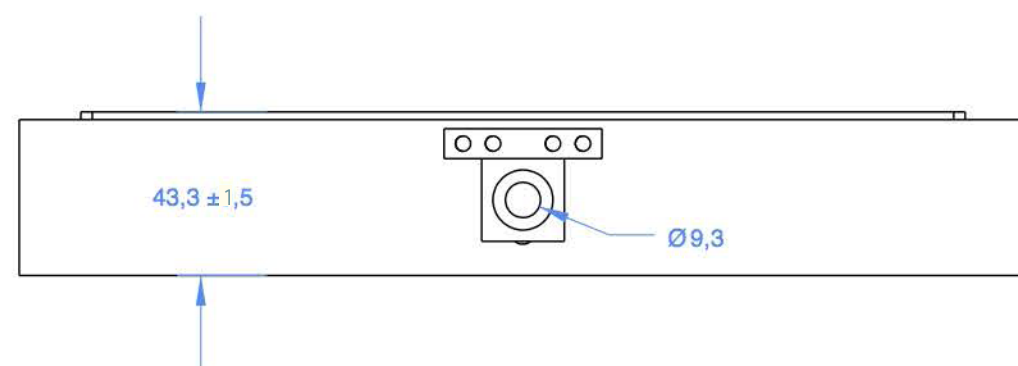
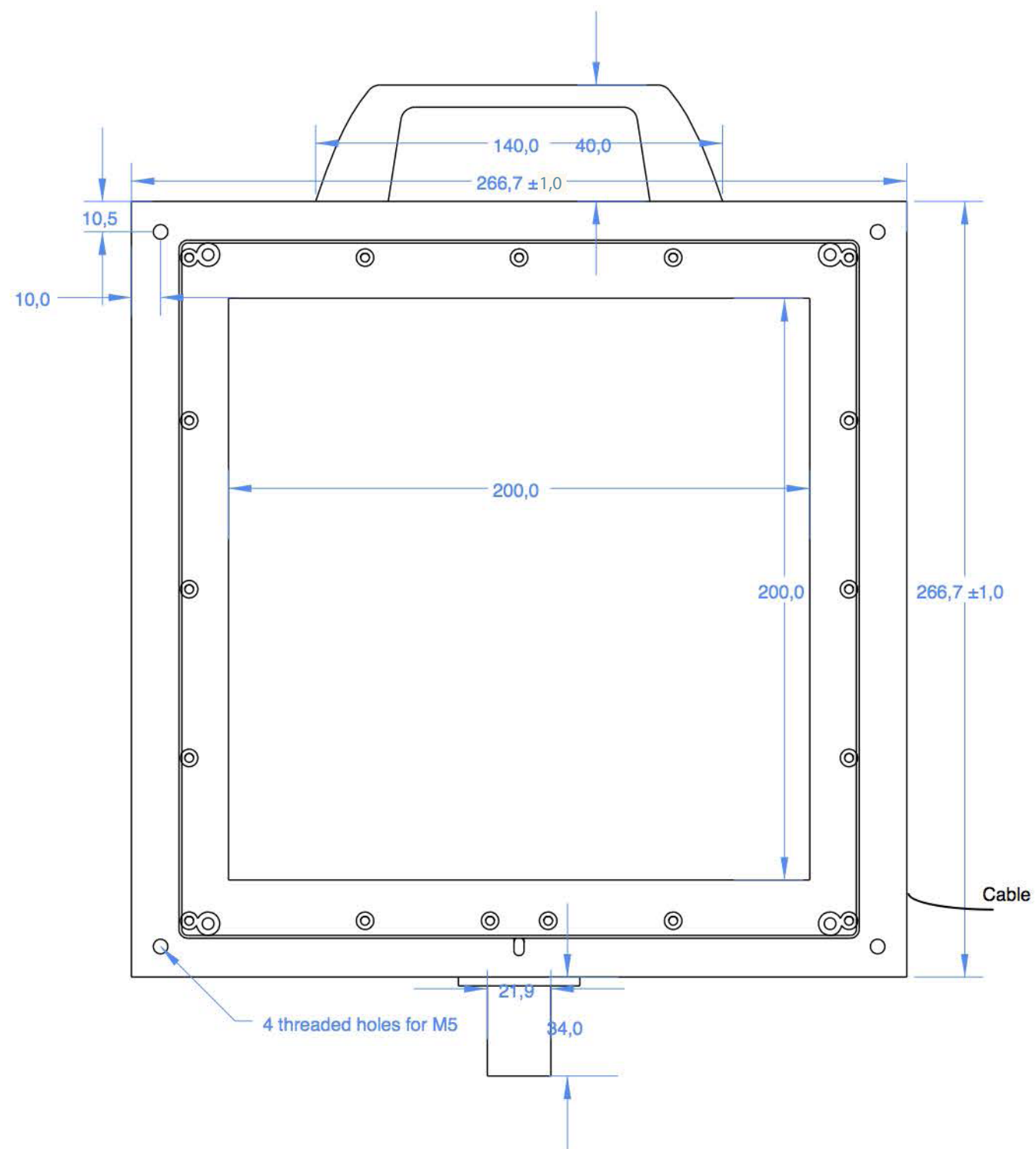

| | |
|---|--|
| PROPRIÉTÉ DE PHLOX SA- REPRODUCTION INTERDITE SAUF ACCORD ÉCRIT | |
| PHLOX-LEDW-BL-200X200-HSCAT-Q-1R-24V | |
| TEL: +33 (0) 4 42 90 76 20 | |